

# VERTICAL SUCTION IN-LINE PUMPS SERIES LD

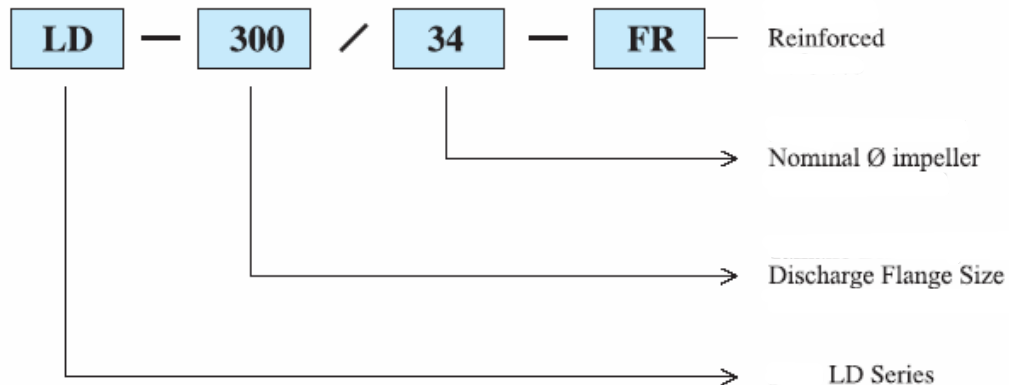

## DESCRIPTION



## MATERIALS

Volute Casing	Cast Iron	Bronze
Impeller	Bronze	Bronze
Casing Cover	Bronze	Bronze
Shaft	Stainless Steel	Stainless Steel

## DESIGN

- IN-LINE vertical suction, double volute centrifugal pump.
- Robust design with 2 grease lubricated ball bearings (not in contact with pumped liquid).
- Flexible coupling .
- Priming by vacuum electropump.
- Low NPSH & high efficiency.

## INTERCHANGEABILITY'

Denomination	Volute	Casing Cover	Shaft	Impeller	Ball Bearings	Mechanical seal	Cover wear ring	Cover wear ring	Gasket	Impeller nut
Ref	1112	1221.1	2100	2200	3011.1/2	4200	1500.1	1500.2	4590.1	2912
Pump Type 300/34	1	1	1	1	1	1	1	1	1	1
300/34-R	1	1	1	2	1	1	1	1	1	1
400/46	2	2	2	3	2	2	1	2	2	2

## PERFORMANCE GRAPHS

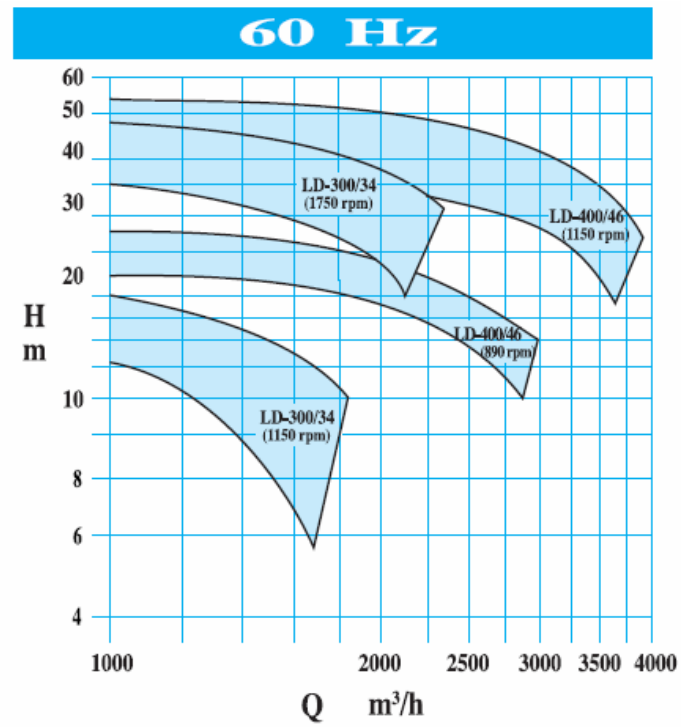
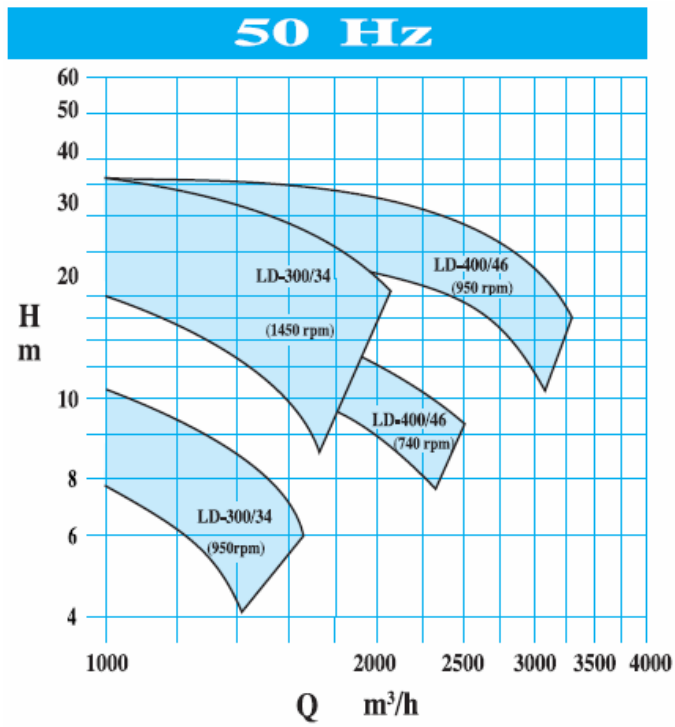

## DIMENSIONS LD 300/34

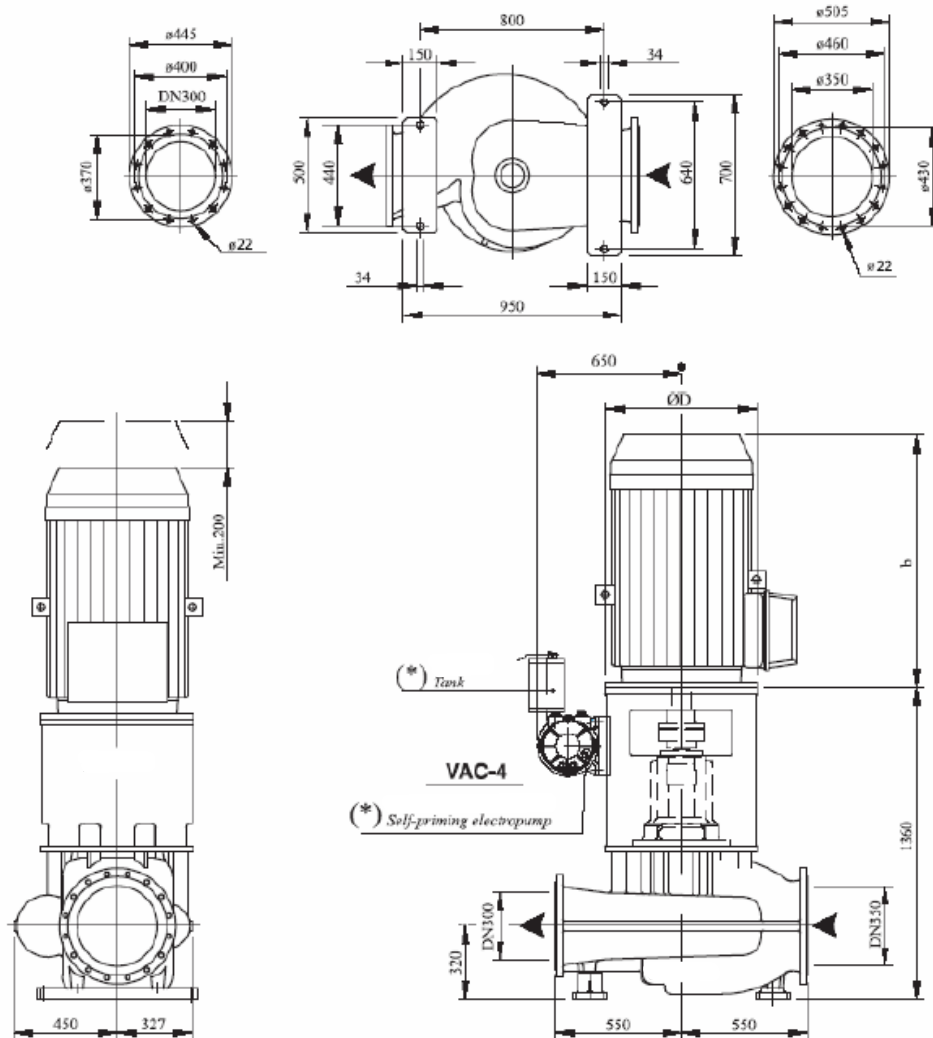

(\*) Optional priming pump & tank

Type	Motor				ØD	b	kg
	R.p.m. / t/min.		R.p.m. / t/min.				
	950	1.150	1.450	1.750			
280SA	45	52	75	86	550	900	1600
280SMA	55	63	90	103	550	1000	1650
315SA	75	86	110	126	660	1000	1850
315SMA	90	103	132	152	660	1100	1880
315MB	110	126	160	185	660	1100	2100
315LA	132	152	200	230	660	1150	2200
355SMA	160	185	250	285	800	1250	2600

Subject to alterations

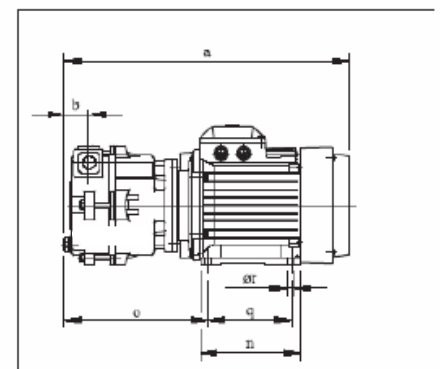

Independent self-priming pump

Type	Motor			a	b	c	e	f	g	h1	h2
	Type	KW	Rpm								
VAC-4	90L-2	2,2	2900	435	37,5	65,5	37,5	182	190	90	65
VAC-6	112M-4	5,5	1450	528	45	118	70	311	272	112	122

Subject to alterations

### LD 400/46

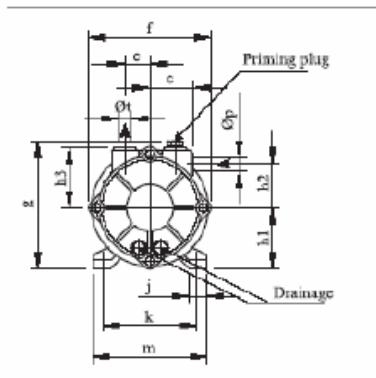
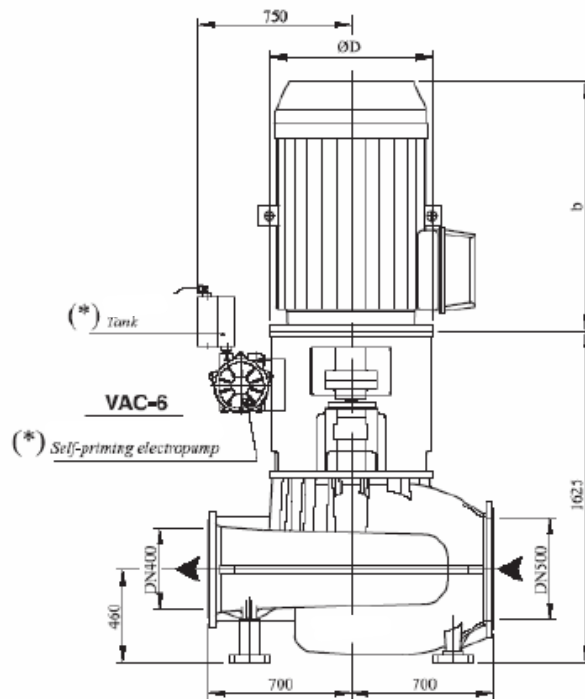
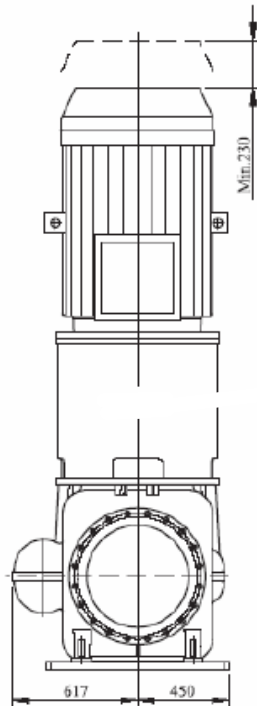
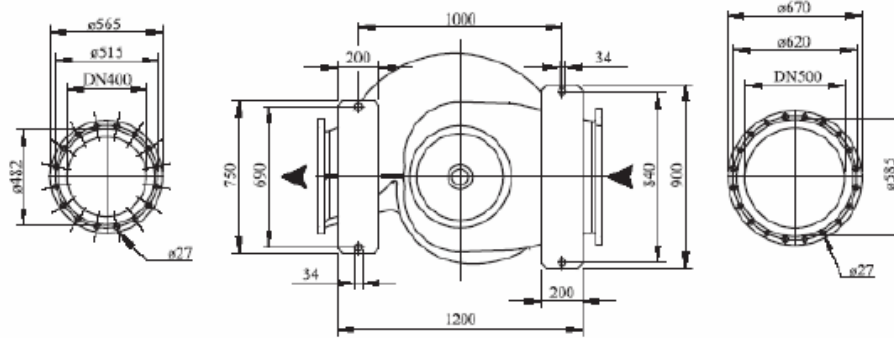

Independent priming pump

h3	j	k	m	n	o	q	Ør	Øp	Øt	kg.
90	27	140	170	150	220	125	10	ISO G1/2	ISO G1/2	25
160	47	190	222	168	270	140	12	ISO G1	ISO G1	80

(\* Optional priming pump & tank

Type	Motor				ØD	b	kg.
	R.p.m. / t/min.	R.p.m. / t/min.	R.p.m. / t/min.	R.p.m. / t/min.			
315SMA	75	86	90	103	660	1100	2475
315MB	90	103	110	126	660	1100	2575
315LA	110	126	132	152	660	1150	2675
355MA	132	152	160	185	800	1250	3030
355MB	160	185	200	230	800	1310	3250
355LKD	200	230	250	285	800	1450	3600

Subject to alterations

SECTIONAL DRAWING

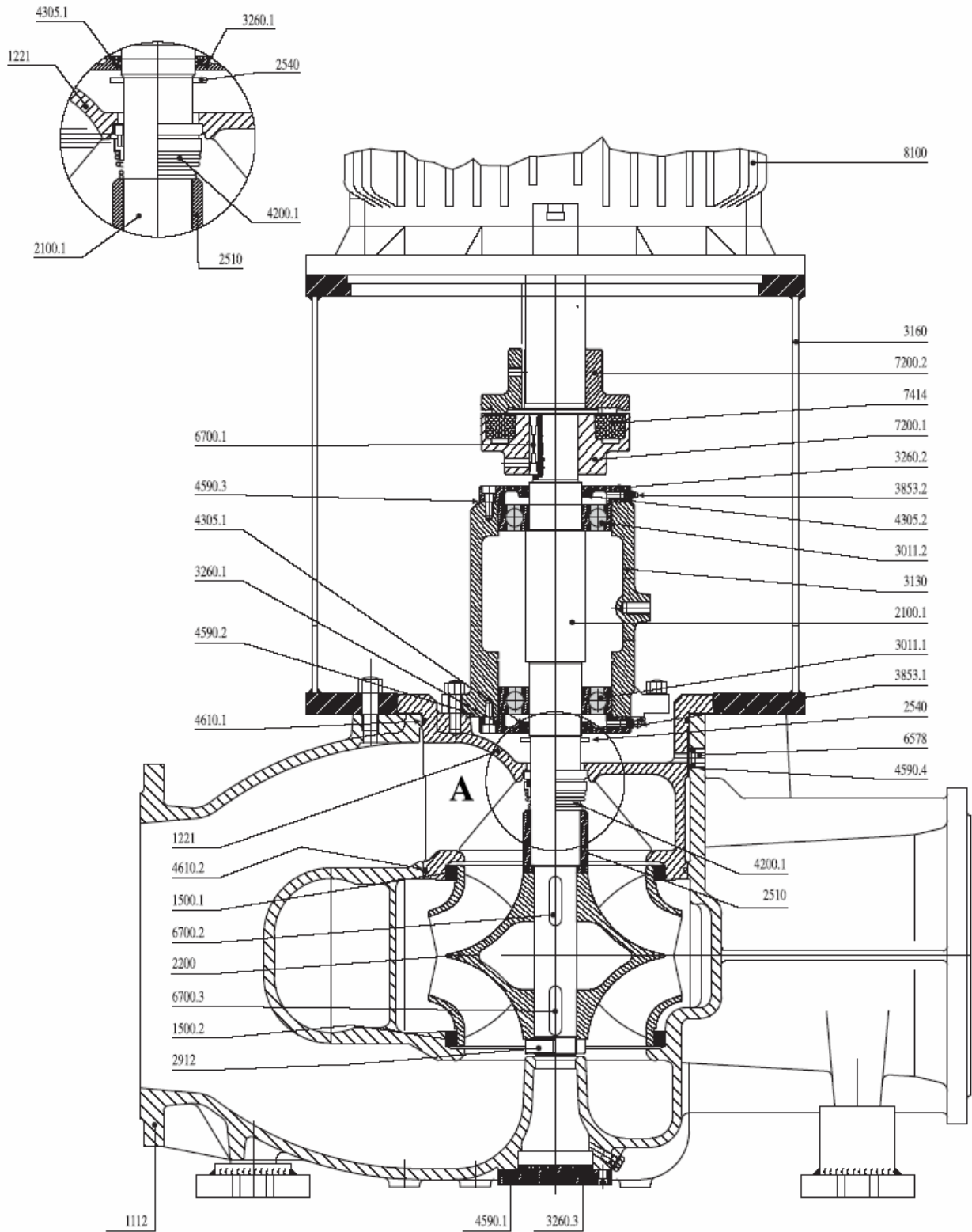

Description	Ref.
Pump Casing	1110.2
Voluta Casing	1112
Casing Cover	1221
Casing Cover	1221.4
Interstage Plate	1471
Casing wear ring	1500.1
Casing wear ring	1500.2
Shaft	2100
Impeller	2200
Impeller	2200.3
Spacer ring	2510
Thrower	2540
Impeller nut	2912
Impeller nut	2912.2
Radial ball bearing	3011.1 / .2
Bearing Bracket	3130
Motor stool	3160
Bearing cover	3260.1 / .2
Bearing cover	3260.3
Grease nipple	3853
Mechanical seal	4200.1
Mechanical seal	4200.3
Shaft seal ring	4305.1 / .2
Gasket	4590.1
Gasket	4590.2 / .3
Gasket	4590 / .4
Gasket	4590.10
O-ring	4610.1
O-ring	4610.2
Screws	6570.5 / .8
Stud	6572.5
Threaded plug	6578
Key	6700.1
Key	6700.2 / .3
Coupling half	7200.1
Coupling half	7200.2
Coupling bush	7414
Motor	8100

### INDEPENDENT PRIMING PUMP

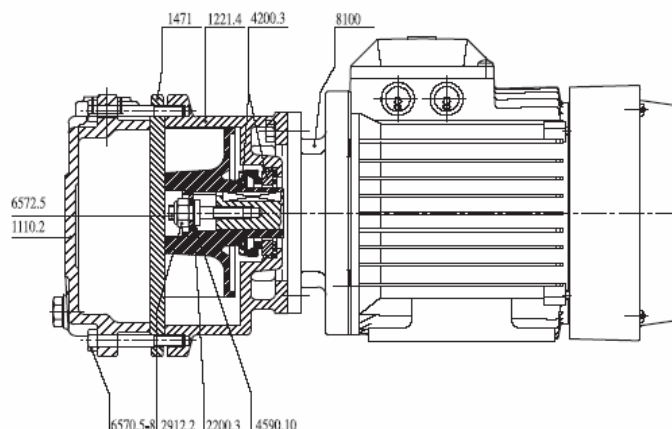

N. VAC4-344-M



Engineered solutions for all your pumping needs

## **Turoteknikk AS**

**-Hildertunet 2  
1341 Slependen, Norway  
-Phone +47 67 80 63 00  
-Fax +47 67 80 63 10  
-mail@turoteknikk.no  
-www.turoteknikk.com**